

REVISIONS		
NO.	DESCRIPTION	DATE

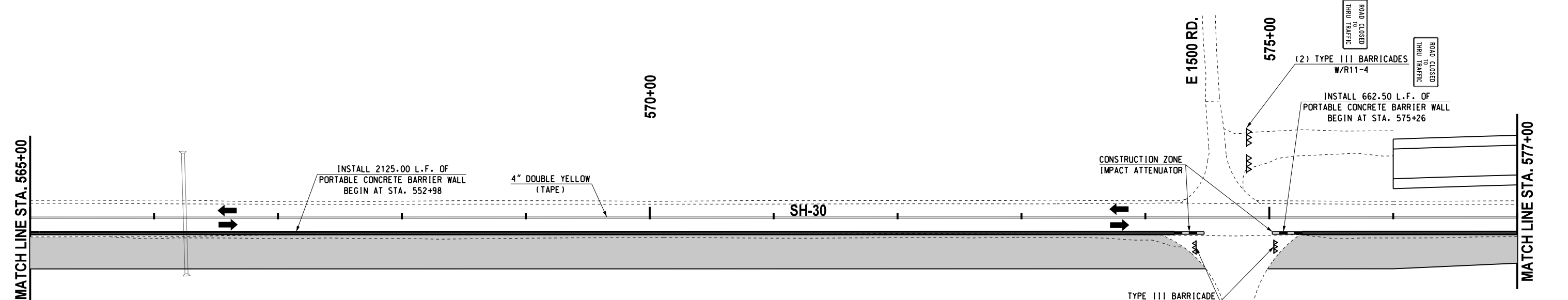

**CONTRACTOR SHALL KEEP  
11' MINIMUM LANES UNLESS  
NOTED OTHERWISE.**

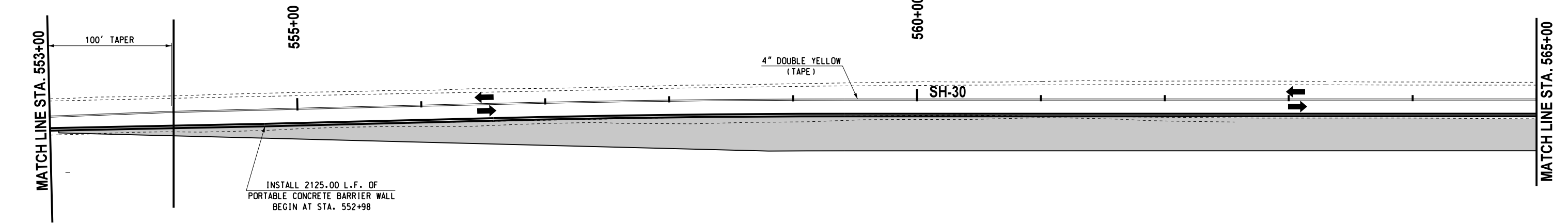
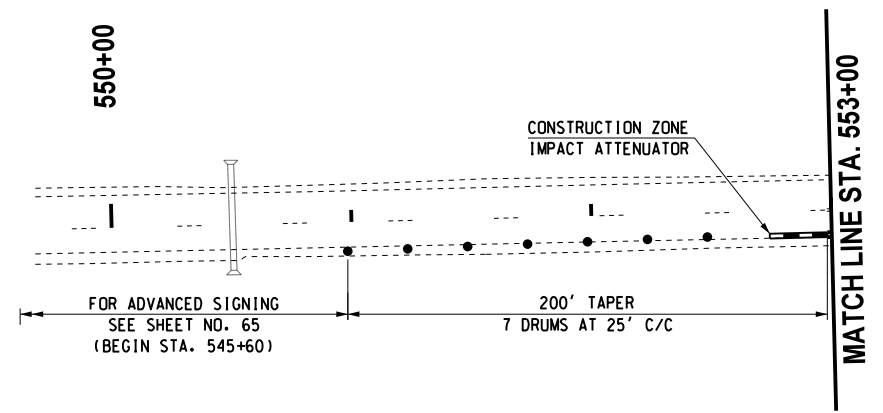

**SUGGESTED SEQUENCE OF CONSTRUCTION**

- PHASE 2. SHIFT TRAFFIC WEST TO EDGE OF SH-30 (ONE LANE EACH DIRECTION)
- PLACE PORTABLE LONGITUDINAL BARRIER ALONG EAST EDGE OF EXISTING PAVEMENT
  - CONSTRUCT TEMP. CROSS DRAINS USING FLAGMEN
  - CONSTRUCT TEMP. ASPHALT WIDENING (C.L. SURV. SH-30 STA. 553+07 TO STA. 581+82 AND STA. 594+28 TO STA. 623+73)

LEGEND	
	- TYPE III BARRICADE W/ TWO TYPE "A" LIGHTS
	- DRUM
	- CHANNELIZER CONE
	- PORTABLE CONC. BARRIER WALL
	- CONSTRUCTION ZONE IMPACT ATTENUATOR
	- WORK AREA

Design	RWR	9/13/2016
Drawn	CCC	9/13/2016



TRAFFIC CONTROL PLANS  
PHASE 2  
(1 OF 3)

State Job No. 28768(04) Sheet No. 68

9/13/2016 G:\DIP\Projects\1-2356 SH 30 over Salt Fork of Red River\CAD\TC PHASE 2\AC - l.dgn

S.H. 30 BRIDGE & APPROACHES HARMON COUNTY